

LÍNEA DE ESCURRIMIENTO
JUNTAS
ESCALA 1:500

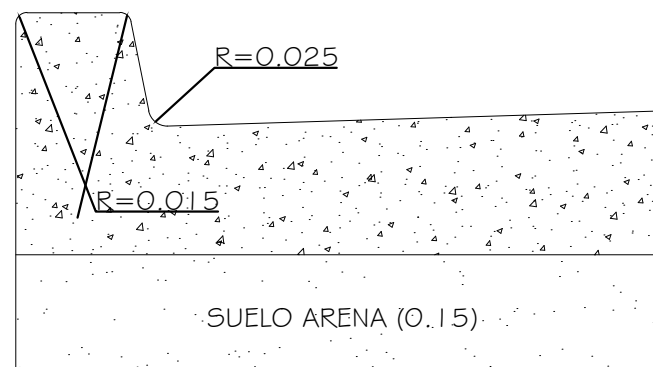

DETALLE CORDON CUNETA
ESCALA 1:10

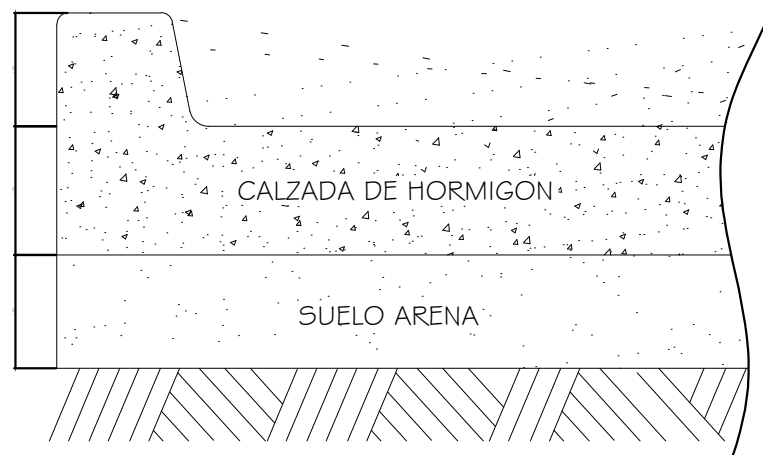

DETALLE CALZADA
ESCALA 1:10

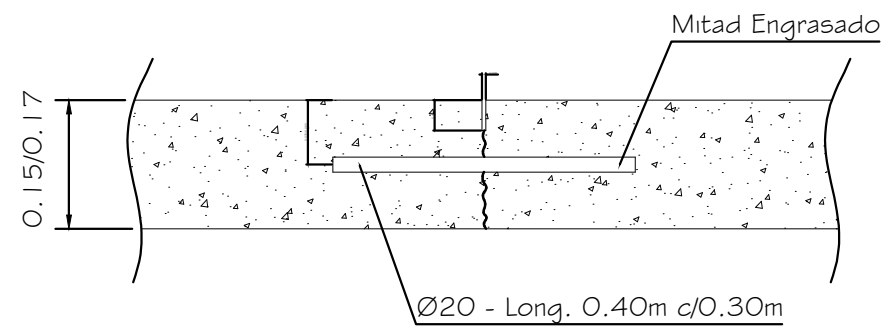

JUNTA TRANSVERSAL DE CONSTRUCCION
ESCALA 1:10

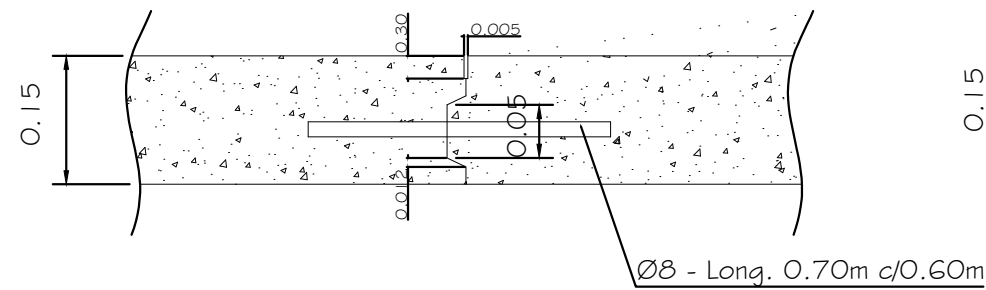

JUNTA DE CONSTRUCCION TIPO
ENSAMBLADA (LONGITUDINAL) (5)

ESCALA 1:10

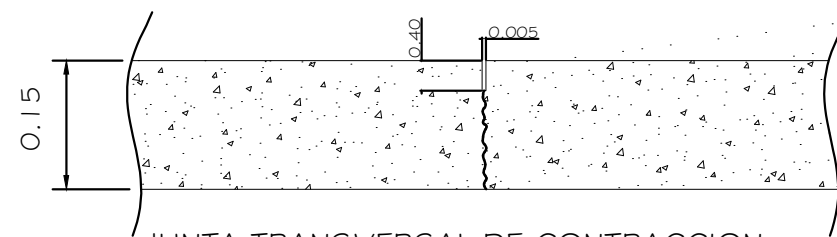

JUNTA TRANSVERSAL DE CONTRACCION
SIN PASADORES (2b)
ESCALA 1:10

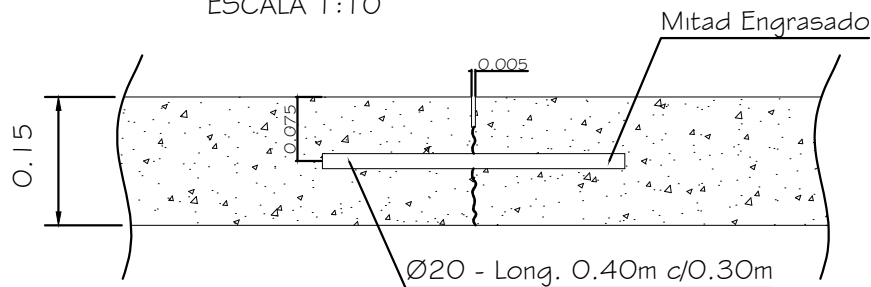

JUNTA TRANSVERSAL DE CONTRACCION
CON PASADORES (2a)
ESCALA 1:10

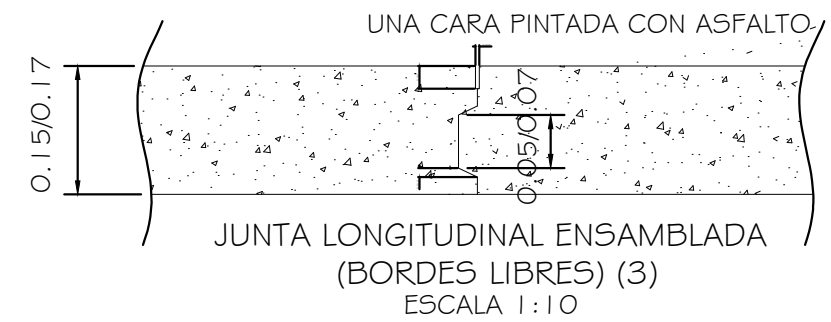

JUNTA LONGITUDINAL ENSAMBLADA
(BORDES LIBRES) (3)
ESCALA 1:10

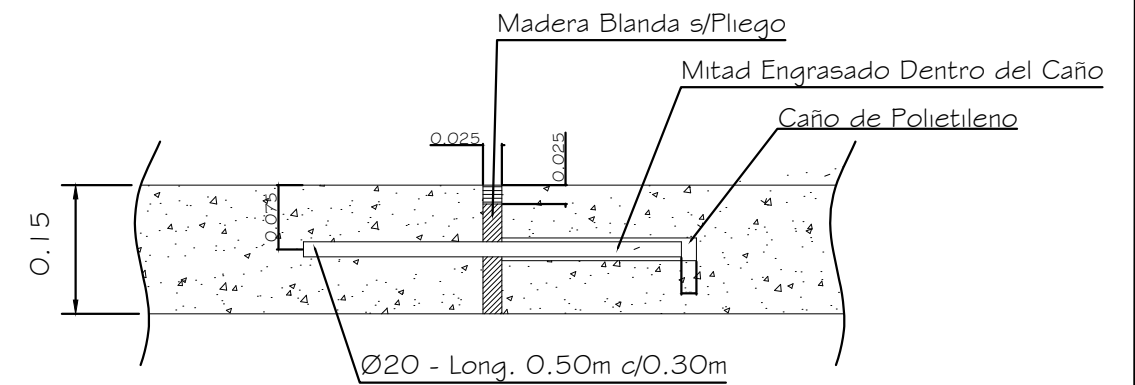

JUNTA TRANSVERSAL DE EXPANSION (4)
ESCALA 1:10

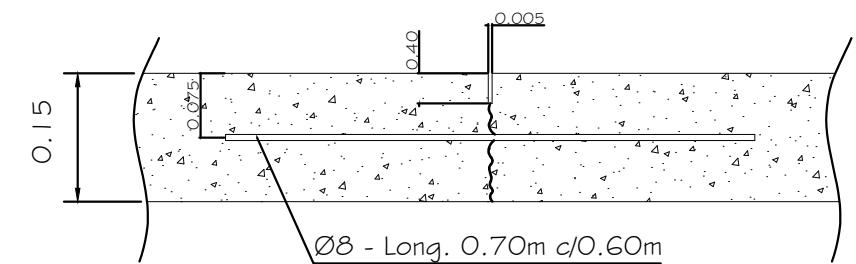

JUNTA LONGITUDINAL DE ARTICULACION (1)
ESCALA 1:10



AREA TECNICA		PROYECTO		PAVIMENTACION COLOMBRES	PROVINCIA:	DETALLES HORMIGON	LAMINA
ING. SUREDA SEBASTIAN	ING. PALANDRI JOSE LUIS	MUNICIPALIDAD DE RIO CUARTO SECRETARIA DE OBRAS PUBLICAS AREA INFRAESTRUCTURA VIAL	VERSION N°		FECHA		APROBACION
						MUNICIPALIDAD DE RIO CUARTO	De. 03